

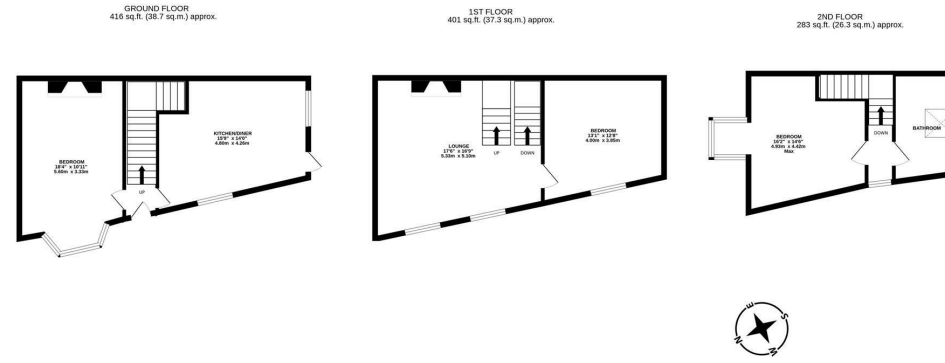

Fully Refurbished with No Onward Chain!
 Located on the corner of Beaconsfield Street, Fenham, this well presented three bedroom terraced home is situated close to local schooling and the shops and amenities of Stanhope Street, the property is also well placed for easy access into Newcastle City Centre via the transport links which can be found on both Studley Terrace and Westgate Road.

Set over three floors, the accommodation briefly comprises: entrance hall with stairs to first floor; kitchen diner with a range of fitted units, work surfaces, dual aspect windows and side door access to the yard; bedroom three with feature fireplace and walk in bay; to the first floor, open to the stairs, 17ft lounge with dual windows and feature fireplace; bedroom one. The second floor landing gives access to; bedroom two with dormer window providing open aspect views; generous bathroom complete with four piece suite including a free standing bath and step in shower. Externally, a gravelled front town garden with railings and an enclosed yard with wall boundaries. Early viewings are advised to avoid disappointment!

Three Bedroom End-Terrace | Three Storeys | Fully Refurbished | 1,101 Sq ft (102.2m²) | Lounge | Kitchen Diner | Bathroom | Open Aspect Views | Front Town Garden | Enclosed Yard | No Onward Chain | Freehold | Council Tax Band | EPC: Rating D



TOTAL FLOOR AREA: 1101 sq.ft. (102.2 sq.m.) approx.
 Whilst every attempt has been made to ensure the accuracy of the floorplan contained here, measurements of doors, windows, rooms and any other items are approximate and no responsibility is taken for any error, omission or mis-statement. This plan is for illustrative purposes only and should be used as such by any prospective purchaser. The services, systems and appliances shown have not been tested and no guarantee as to their operability or efficiency can be given.
 Made with Metropix ©2026

Offers Over £175,000

IMPORTANT NOTE: These particulars and the descriptions and measurements herein do not constitute representation and whilst every effort has been made to ensure accuracy, this cannot be guaranteed.

